

# dank.

## Installation Guide

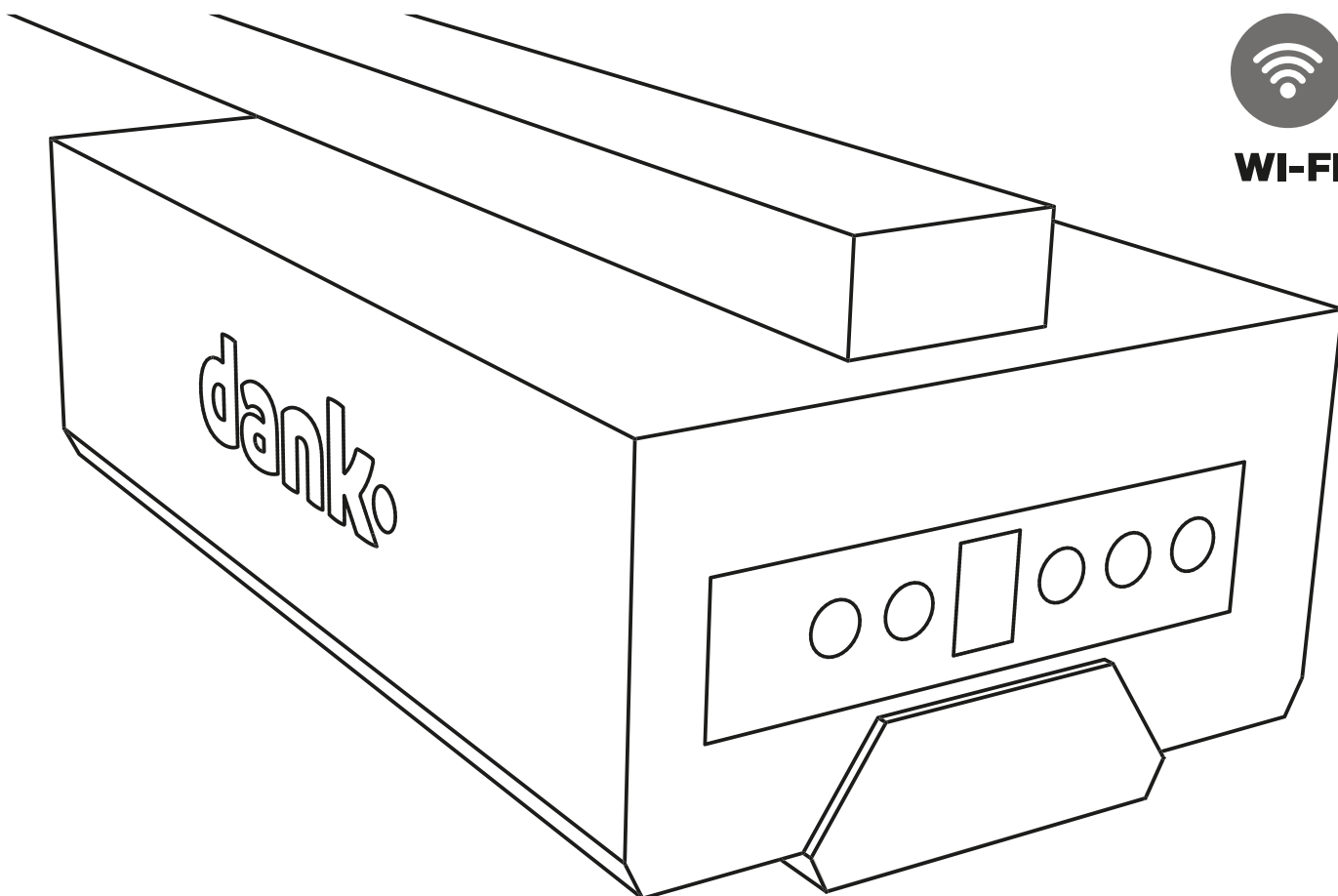

WI-FI



The easiest automation system to install

# K10

## Garage Door Opener

# Contents

About This Manual	01
Features	02
Package Contents	03
Assembly Instructions	04
Motor Setup	08
Control Programming	11
Additional Features	12
Diagram	13
Troubleshooting	14

# User Manual

Thank you for choosing this garage door opener. For safe and effective use, please read the user manual and safety instructions before operating the equipment, and follow all guidelines. Always keep the manual near the motor. If needed, have a professional demonstrate how it works before first use.

## **This garage door opener is intended only for...:**

- For installation in private residences only
- Designed for automatic opening and closing of garage doors
- Must be installed and used according to the safety instructions provided in this manual.

## **Note!**

- Immediately replace any damaged power cables. This must be done by a qualified electrician.
- Follow each step in the order outlined, and make sure you are familiar with how the system operates.
- Keep the motor remote control in a secure place to prevent accidental use. Children should not play with the remote.
- This motor is suitable only for properly installed and balanced garage doors. Improper installation could lead to personal injury.
- Always disconnect the power supply before working on or moving the garage door.
- Never touch the garage door motor or insert objects while it is in motion.
- Make sure all users understand how the garage door motor works and its features.
- Use only the materials provided or recommended, along with original spare parts and accessories.
- The bottom edge and sides of the garage door motor and its mechanism pose a risk of crush or cut injuries. Only open or close the garage door when you can clearly see the full range of movement and no one else is in the area.
- If the garage door motor is malfunctioning, contact your dealer or the manufacturer's customer support.

## **Emergency Release from Outside.**

If there's no other way into your garage, always make sure to install an emergency release option.

## **Closing the Door**

Before installing the garage door opener, remove or disable any existing locking devices on the door once the opener is closed and locked.

# Features

- Control with the app via Wi-Fi
- Automatic light  
The light stays on for 5 minutes after opening, then turns off automatically **02**
- Reduced speed at the end of opening/closing  
Smooth and quiet start, gentle stop to safeguard the motor and extend its lifespan
- Automatic stop  
The garage door halts and slightly reverses if it encounters an obstacle
- Adjustable opening/closing power and distance  
A The opening/closing power can be set from 1 to 8, with level 8 being the highest.  
You can customize the open/close distance during setup.
- Programmable automatic closing feature  
The The garage door motor can be set to close automatically after a selected amount of time.
- Includes 2 remote controls. Each remote can operate up to 2 garage doors. One button lets you open, stop, or close the door.
- Option to add a manual open/close switch (extra accessory – see separate section)

# What's Inside the Box

Please unpack the garage door opener with care and make sure you've removed all components.

Item	Quantity
Rail	3
Chain	1
Trolley	2
Rail Joint	2
Motor	1

Item	Quantity
Controls	2
Ceiling Mounts	2
Release Cord	1
Screws and Accessories	1
Connector Rod	1



# Assembly Instructions

Before you begin assembling, measure the gap between the garage door panel and the ceiling. Make sure there's at least 5 cm of clearance above the garage door so it can move through its full range of motion.

If the gap is greater than 14 cm, the garage door opener should be installed hanging from the ceiling using the included hardware.

If the clearance between the ceiling and the garage door is less than 5cm, please contact your dealer.

## Carriage Assembly

To assemble the carriage, fit the two mounting sections around the center section of the rail, then secure the remaining rail sections. Place the sprocket in position and wrap the chain around it. Make sure the chain runs straight along the rail and isn't twisted.

Check that the carriage lock catch is positioned correctly on the carriage.



Tighten the chain using a 14mm wrench on the nut at the end opposite the sprocket. Make sure the chain is secure so it doesn't slip off the track.

Check that the chain is still properly seated on the sprocket. The sides of the chain should not touch the bottom of the track.



## Cart Assembly

Insert the locking key into the plastic block using the connecting rod for the garage door. Make sure the spring is attached to the release key.

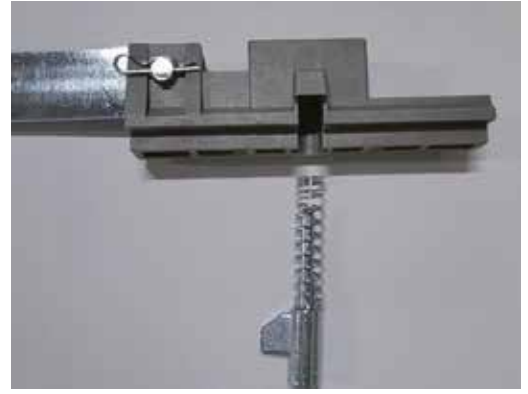

Insert the plastic lever arm fully into the plastic block and secure it with the supplied split pin.

Attach the cord to the handle to enable emergency release on the plastic lever.

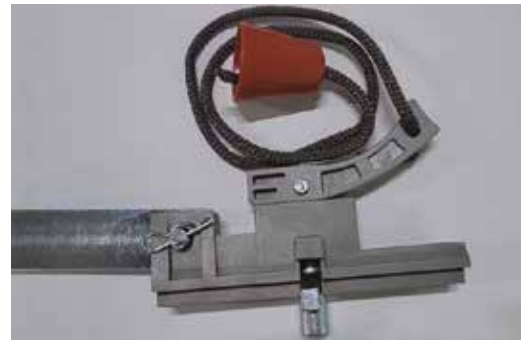

Now secure the plastic block to the trolley using the four supplied machine screws.

Please note: you'll need to take out the connector rod from the plastic block so that you can insert the screw into the hole.



## Trolley Functions

- A. **Lock:** When you release the pull cable, the trolley's locking mechanism will automatically engage, allowing the garage door to open and close. This is the trolley's auto-reset feature.
- B. **Unlock:** When the control arm moves into the trolley, fully pull the cable to disconnect the trolley's lock from the control arm, so you can manually raise or lower the garage door.
- C. **Automatic Locking:** If the trolley is separated from the chain's control arm, the garage door will lock itself.

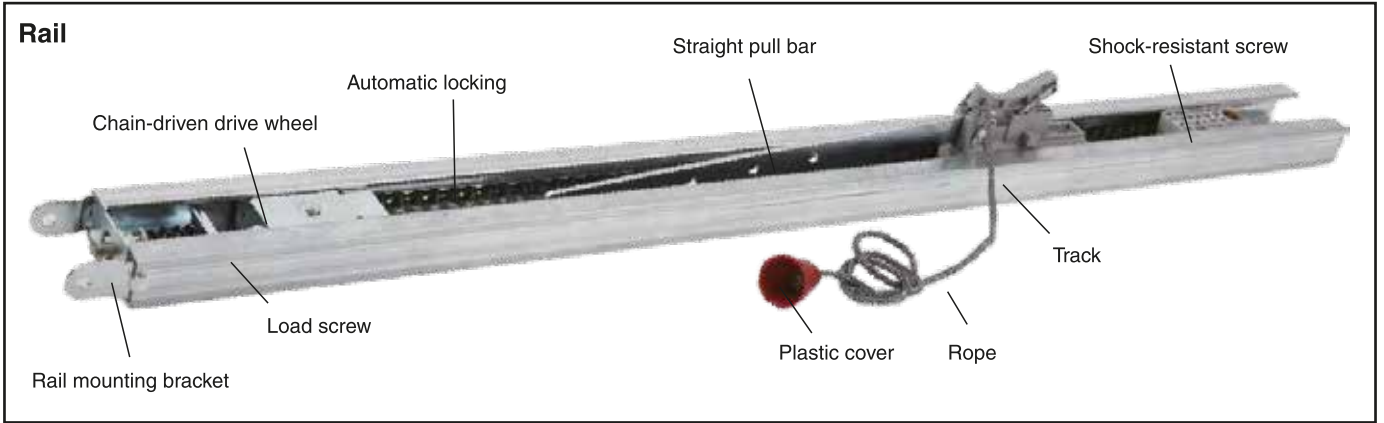

**Mounting on the garage door**



Install the bracket to secure the track above the garage door.



Place the traction bracket at the center of the garage door



Attach the door rail to the hardware with the included shaft, then insert the cotter pin to secure it in place.

## Motor Assembly

Attach the motor unit to the door rail using the two included brackets.



## Hook Installation

Only use the brackets if the gap to the ceiling is greater than 14cm. Shape the brackets as needed. If there's a suitable beam, the rail can be fastened to it with the provided bracket. Snap the clip around the rail and position the bracket over it, then secure everything with the supplied nuts and bolts.

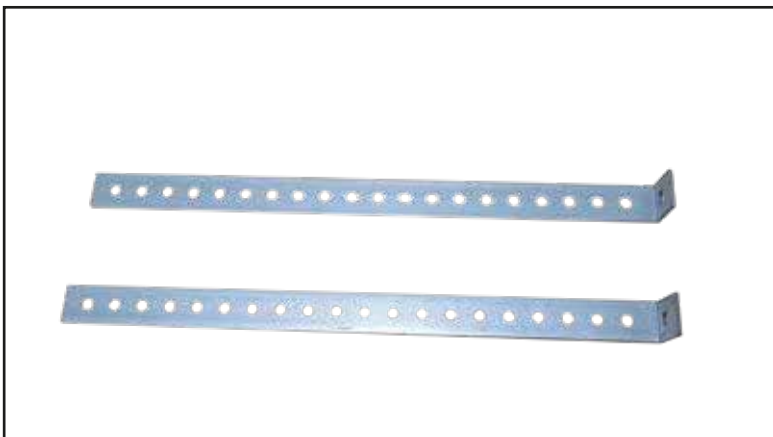

Attach the trolley to the garage door using the included connecting rod. You can use the pre-drilled holes to adjust the angle, ensuring the garage door doesn't touch the connecting rod.



# Motor Programming

## Getting Your Garage Door Ready for the Motor

Start by manually opening and closing the garage door to ensure it moves smoothly and is properly balanced. If the door doesn't operate easily, do not connect the motor to the door.

### Control Panel

1. Wi-Fi Button
2. CODE Button
3. Display Screen
4. Wi-Fi Signal Indicator
5. Down Arrow Button
6. Up Arrow Button
7. SET Button

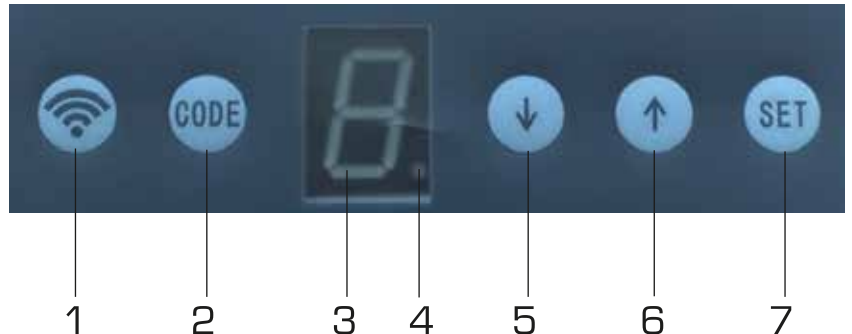

### Motor Adjustment and Operating Instructions

1. When the motor is connected to power, the display will show "O," indicating standby mode.
2. **Setting Opening and Closing:** Press the SET button once. The display will show "1." Press the up arrow until the door reaches the fully open position. Release the up arrow and press SET. The display will show "2." Press the down arrow until the door is fully closed. Release the down arrow and press SET. The door will automatically open and close once to complete the setup.

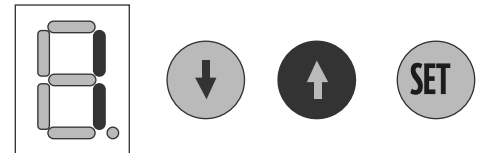

Sets the gate's fully open position.

3. **Adjusting Opening / Closing Force** The opening and closing force can be set between 1 and 8. The default is 3.



Sets the gate's fully closed position.

To set the opening force: Press the SET button three times until the display shows the top section of Fig. 8. Press the up arrow to increase the force, or the down arrow to decrease it.

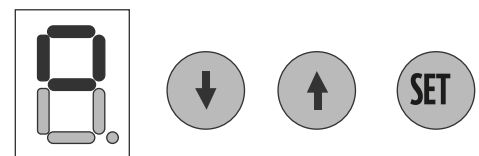

Adjusting the opening force.

Once you've chosen your preferred force, press the SET button to save. The motor will automatically switch to the closing force setting. The display will now show the lower section.

The closing force can be set from 1 to 8. The default is 2.

Press the up arrow to increase the force or the down arrow to decrease it. When you've selected your desired setting, press SET to save until the display shows "O." This means the closing force is set.

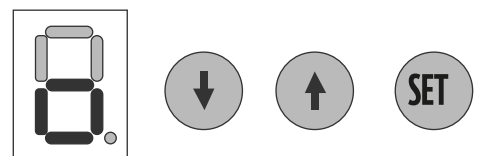

Adjusting the closing force.

4. Automatic gate closing settings:  
How to enable automatic gate closing: Press the SET button 5 times until the display shows “A.” Press the up arrow button and the display will show “1,” which sets the gate to close automatically after 10 seconds. “2” sets it to 20 seconds, and you can go up to “6” for 60 seconds.

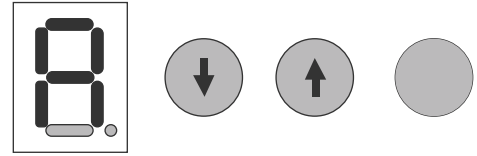

Set the automatic closing time for your gate.

5. Condo Mode: To enable condo mode for the gate, press the SET button 6 times until the display shows “H.” Then press the up arrow button. The display will show a blinking “H,” indicating that condo mode is now active. To turn off condo mode, press the down arrow button until the display shows a steady “H.” This means condo mode is now deactivated.

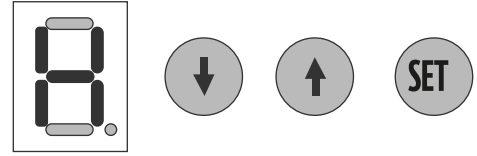

Set up condo mode.

Press the SET button to save all your settings. (Auto-close is turned off by default at the factory.) If you don't want to use auto-close, you can leave the factory setting as is.

The gate will auto-close by default after 5 minutes. This time setting cannot be changed.

**Note: Condo mode ignores all remote or push button commands after the first open command. We recommend using this mode with auto-close enabled.**

### Connect Garage Door Opener to Wi-Fi

#### Getting Started:

Make sure your smartphone is connected to a strong and stable Wi-Fi network.

1. Keep your smartphone close to the garage door opener (about 3–10 feet away, depending on Wi-Fi signal strength) throughout the connection process.
2. Download the “TUYA Smart” app from the App Store or Google Play. Finish the registration process.
3. You can also install the app on your smartphone by scanning the QR Code labeled “Download” in this user manual. To access the user guide for the Tuya Smart app, scan the QR Code labeled “Guide.”



Download Guide



The illustration below shows where the Wi-Fi indicator is located on the motor panel.

The Wi-Fi indicator can display up to three different garage door status signals:



1. Not blinking (Off) = The garage door opener is connected to Wi-Fi **10**
2. Blinking slowly = The garage door opener is not connected to Wi-Fi
3. Blinking rapidly = The garage door opener is ready to connect to Wi-Fi

**Connection**

Follow these steps to set up your garage door opener as a smart device in the app.

**Overview:**

- Open the Tuya app and go to the "Home" screen.
- Tap the "More/Add" icon in the top right corner.
- Select "Add Device".
- Select "Plug (PLAY + Wi-Fi)" as the device you want to add.

Press and hold the WiFi button on the control panel until the WiFi indicator starts flashing quickly. (This means the garage door opener is ready to connect to Wi-Fi.)

Make sure the WiFi indicator on the garage door opener is flashing rapidly. Then tap the "Confirm indicator is blinking" button in the Tuya app on your smartphone. Tap "Flashing Rapidly."

Enter the password for the Wi-Fi network you want your garage door opener to connect to. (For example, your home Wi-Fi.)

Tap "Next." The connection will be set up automatically.

**Connection screenshot:**

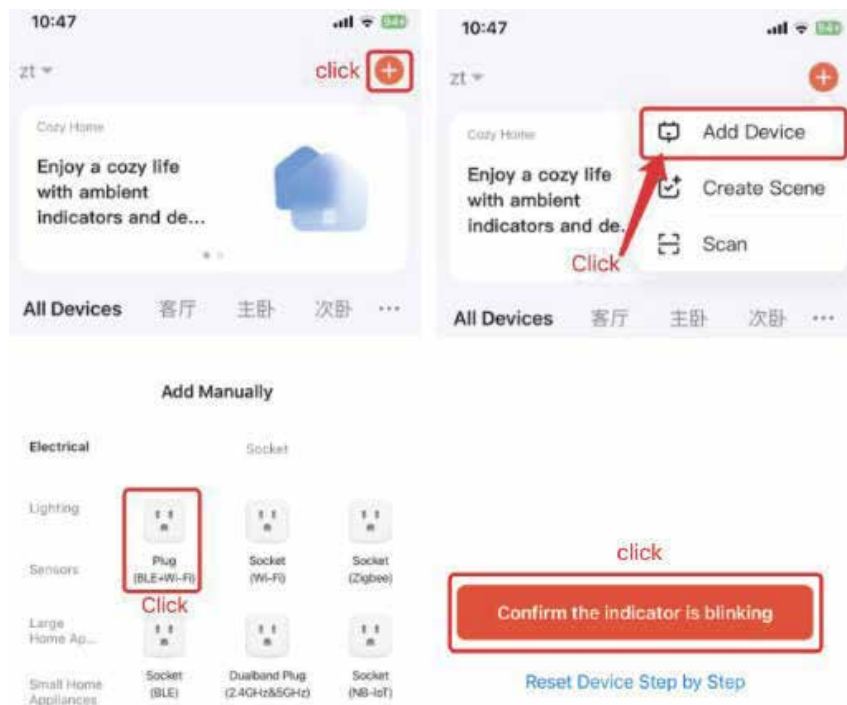

- Make sure the WiFi indicator is blinking quickly, then tap the "Confirm the indicator is blinking" button on your smartphone.
- Follow the remaining steps to complete adding your garage door opener to the Tuya app.

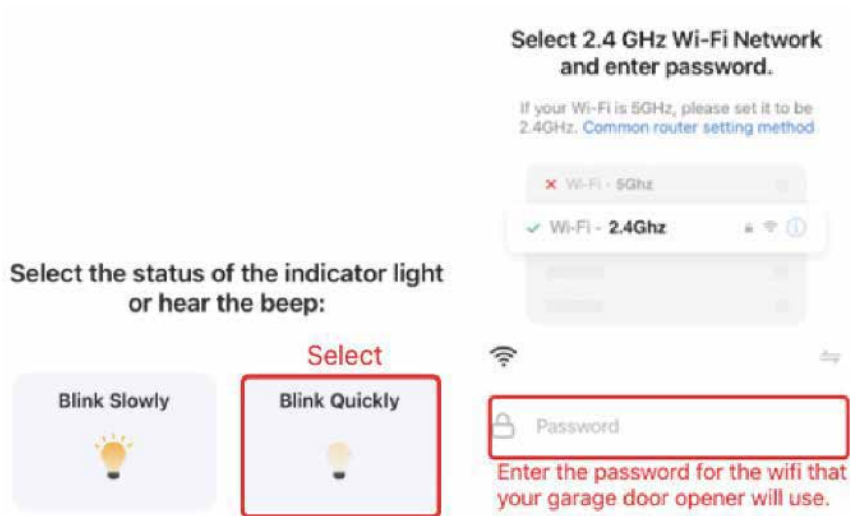

1. Once your garage door opener is connected to your Wi-Fi network, the Wi-Fi indicator will turn off and stay off. **11**
2. You can remove the garage door opener from your current Wi-Fi network by pressing and holding the Wi-Fi button until the Wi-Fi indicator turns on and starts flashing. This means the connection to the previous Wi-Fi network has been disconnected.
3. You can also remove the garage door opener as a device from the Tuya app on your smartphone. Select the garage door opener in the Tuya app and tap "Remove Device" to delete all connected garage devices.

## Remotes

### Add or Remove

- Press the CODE button on the control panel once. The display will show "7". Next, press the button on the remote you want to program twice. The display will show a flashing "7". This means the remote has been successfully added. (Remotes included with your device are already programmed and do not require additional pairing.)
- Each remote can control up to 4 garage door motors, as long as you program one button for each motor.

### To delete a remote from the garage door opener:

- Press and hold the CODE button for 4-5 seconds. The display will show "7," then it will start blinking and turn off.
- Once "7" turns off, the screen will show "0" and enter standby mode. This means all remote codes have been cleared from the garage door opener.

## Remote Battery Replacement

### Warning!

- Risk of improper battery replacement. Only use batteries of the same type or an approved equivalent.
- Use leak-proof batteries. **12**
- Loosen the screws on the back of the remote and remove the cover.
- Replace the battery.
- Make sure the (+/-) terminals are properly aligned. Place the negative end against the spring contact.
- Put the cover back on and screw it into place.

## Wireless Keypad (optional accessory, sold separately)

The wireless keypad should be set up as follows:



Press the CODE button on the control panel once. The display will show "7." Enter "11" and press the left arrow button. Enter "11" again and press the left arrow button once more.



The display will show a flashing "7." This means the wireless keypad has been successfully added. (Remotes included in the package are already paired and do not need additional setup.)

Each numeric keypad can control up to two motors, allowing you to assign an arrow button function to each motor.

The default factory code is 11 for the left arrow button and 22 for the right arrow button. You can set a new code by following the instructions included with your wireless keypad.

You can purchase additional accessories for your garage door opener, such as an extra remote, an external digital keypad, emergency opener, replacement batteries for remotes, and an extension rail to fit garage doors over 240 cm tall.

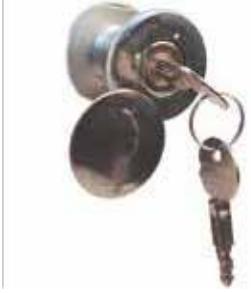
Item No.	Description	Image
	Remote control with three-button operation. Battery included. Works up to 35 meters away. Note: Can operate up to three garage door motors.	
	Wireless digital keypad for outdoor use with a personal code up to 8 digits, no transmitter or key required. Can be mounted outside the garage. Comes with a CR2032 coin cell battery. Allows programming of two separate codes, so you can use it with two different garage door motors or one motor with two distinct codes.	

	<p>The garage door release lets you unlock the door from the outside. Using a key, you release the cable and disconnect the door from the opener, so you can open it manually. Ideal for use during power outages. Install if there's no other way into the garage. Comes with two keys.</p>	
	<p>Extension for track accessories 50 cm. The garage door opener can be extended up to 3 x 50 cm. With one extension, the motor can lift a door up to 290 cm high. Two extensions handle doors up to 340 cm. Three rail extensions handle doors up to 390 cm for tall.</p>	

open

## Wiring Diagram for Connectors and Devices

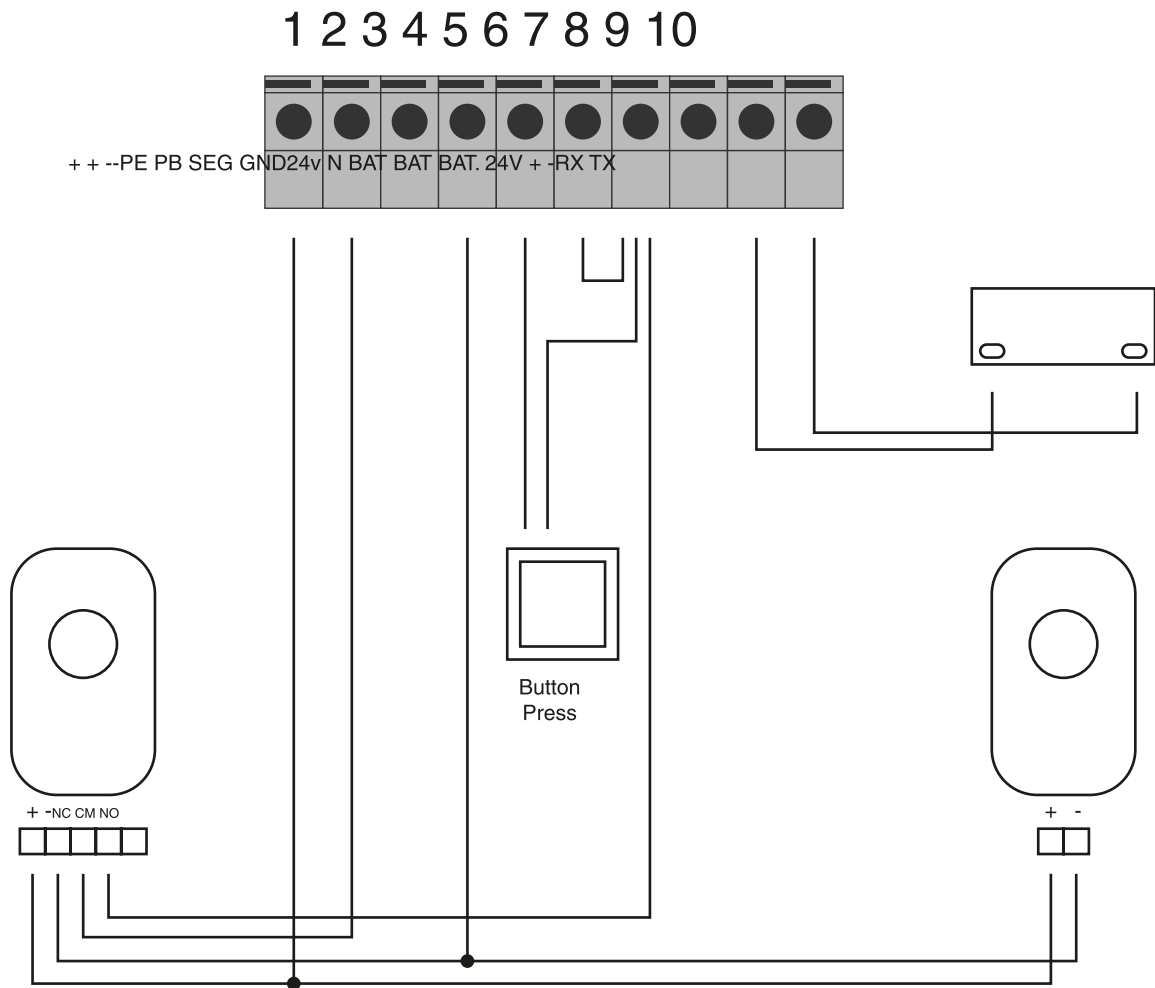

**Note:** The security system is shipped with a factory-installed shunt. If you want to connect a security device to the gate, remove the shunt from connectors (6 and 7) and connect the device.

## Inspection and Maintenance

Always unplug the garage door opener before performing any work. This product is designed for long-lasting, trouble-free operation with minimal upkeep. Regular cleaning and proper use will help extend its lifespan. Lubricate the chain periodically and keep an eye on the garage door as it opens and closes to make sure everything is working smoothly. Check that all bolts and nuts are tightened securely.

## Troubleshooting

Issue	Cause	Solution
The motor isn't working	<ul style="list-style-type: none"> <li>Blown fuse</li> <li>Loose connection</li> </ul>	<ul style="list-style-type: none"> <li>Replace the fuse</li> <li>Check the connection</li> </ul>
After setting the open and close positions, the motor doesn't operate	<ul style="list-style-type: none"> <li>Motor mounting nuts are loose</li> <li>Programming error</li> </ul>	<ul style="list-style-type: none"> <li>Tighten the nuts</li> <li>Reset the open and close positions</li> </ul>
The wall switch works, but the remote doesn't.	<ul style="list-style-type: none"> <li>The remote hasn't finished the auto-learning process</li> <li>The remote's battery is low</li> </ul>	<ul style="list-style-type: none"> <li>Program the garage door opener remote</li> <li>Replace the remote or its battery</li> </ul>
The remote only works when close to the garage door opener	<ul style="list-style-type: none"> <li>The remote's battery is almost dead</li> </ul>	<ul style="list-style-type: none"> <li>Replace the remote's battery</li> </ul>
The garage door stops while operating	<ul style="list-style-type: none"> <li>The safety device or wall switch has been triggered</li> </ul>	<ul style="list-style-type: none"> <li>Remove any obstruction</li> </ul>
The garage door won't respond to the remote or the wall switch	<ul style="list-style-type: none"> <li>The garage door detected an internal error and the display flashed during the test</li> </ul>	<ul style="list-style-type: none"> <li>Disconnect the opener from power and wait 5 seconds. If the issue persists, contact the manufacturer</li> </ul>
The garage door doesn't open all the way	<ul style="list-style-type: none"> <li>Programming is incorrect</li> <li>The door is damaged</li> <li>Weather conditions like rain or snow may have added weight to the door</li> </ul>	<ul style="list-style-type: none"> <li>Reprogram the opener</li> <li>Call a professional to repair the door</li> <li>If the opener senses extra weight as an obstacle, increase the motor force. Remove water or snow from the door</li> </ul>
The light isn't turning on	<ul style="list-style-type: none"> <li>Faulty bulb</li> </ul>	<ul style="list-style-type: none"> <li>Replace the bulb</li> </ul>



**Daportas Automatics, LLC**  
1691 Industrial Street  
4750-841 Barcelos, Portugal

+351 253 891 418  
info@daportas.pt

**daportas.pt**